

BAAN BAAN

Vibhavadi 20

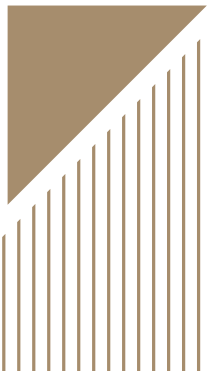

A Simple Concept

In English language, the terms 'house' and 'home' both refer to a place of residence while in Thai, the word '*Baan*' is used exclusively to denote a family's dwelling. '*Baan*' for Thais holds a profound significance, representing a place where familial emotional bonds are nurtured. The distinction between the English terms 'house' and 'home' then become less pronounced in Thai context.

'*Baan*' transcends its physical structure and encompasses love, serving as the heart of the family, a sanctuary for happiness, and a space where all family members can find both physical and mental solace.

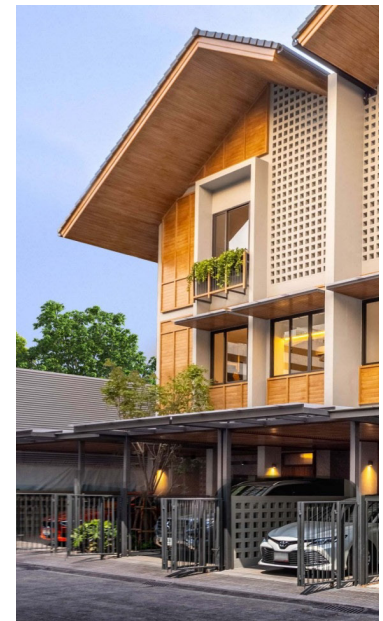

***'Baan'* for all Family Members**

'Baan Baan Project' is thoughtfully designed with a contemporary and simplistic approach, aiming to create a harmonious abode for all family members. *'Baan Baan'* offers a wide range of spaces to cater to various activities, and the inclusion of a lift which ensures accessibility for family members of all ages. Our vision for *'Baan Baan Project'* extends beyond its current state as we aspire for it to evolve into a thriving and close-knit community of exceptional quality in the future.

***'Baan'* of Tropical Wisdom**

Embodying the essence of tropical wisdom, *'Baan Baan'* is thoughtfully designed to harmoniously blend with nature. Drawing inspiration from the lifestyles of tropical regions, *'Baan Baan Project'* features a high basement floor for enhanced structural integrity, strategically placed eaves to provide ample shade and fend off solar heat and glare, numerous windows to facilitate optimal ventilation, and an intelligently designed L-shaped tree line which effectively reduces heat and promotes better air circulation, all of which are believed to foster sustainability and a genuine connection to the natural world.

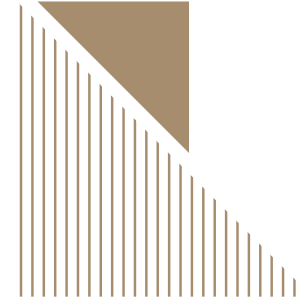

***'Baan'* of Low Maintenance**

We are committed to constructing homes that provides you with secure and worry-free living expenses. To ensure this, we meticulously craft each house using premium materials known for their durability and longevity, effectively reducing future maintenance expenses and lightening the burden on homeowners. Our dedication to creating sturdy and robust dwelling stems from our desire to grant you peace of mind and enhance your overall quality of life.

Baan Baan Vibhavadi 20

The houses that have been disappearing from Thai society are those lacking climate consciousness. Embracing climate-appropriate houses reflects the epitome of genuine living for individuals in a tropical country like Thailand. In our '*Baan Baan Project*', we embrace the concept of tropical architecture which strives to harness nature's full potential to enable a most comfortable living experience for those dwelling in the tropics.

Company Name : Rising Plus Development Co.Ltd
Project Name : Baan Baan Vibhavadi 20
Project Size : 2-1-42 Rai
Number of Units : 10 units
3 Story- semi detached Houses : 347 sq metres of floor space
: plot area starting from 46 Sq. wah
: lift
: 3 Parking Space
: 3 Bedrooms / 4 Bathrooms
1 multi-purpose Room
1 Maid's Rooms

3 - Storey : 620 Sq metres of usable area
Detached House : Plot area starting from 87.5 Sq wah
: lift
: private swimming pool
: 6 Parking Space
: 5 Bedrooms / 6 Bathrooms
1 multi-purpose Room
2 Maid's Rooms

MASTER PLAN



PERSPECTIVE SINGLE HOUSE

3 Story Detached House with 620 Sq. metres of Usable Area



1st FLOOR PLAN



2nd FLOOR PLAN



3rd FLOOR PLAN



5 Bedrooms



6 Bathrooms



1 Multi-purpose
Room



6 Parking
Space



2 Maid's Rooms



Lift



Swimming Pool

EXTERIOR

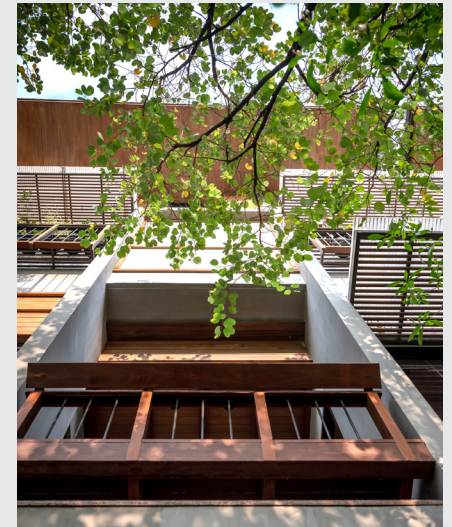

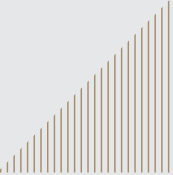



INTERIOR



PERSPECTIVE TWIN HOUSE

3 Story Semi-detached House with 347 Sq. metres of Usable Area



1st FLOOR PLAN



2nd FLOOR PLAN

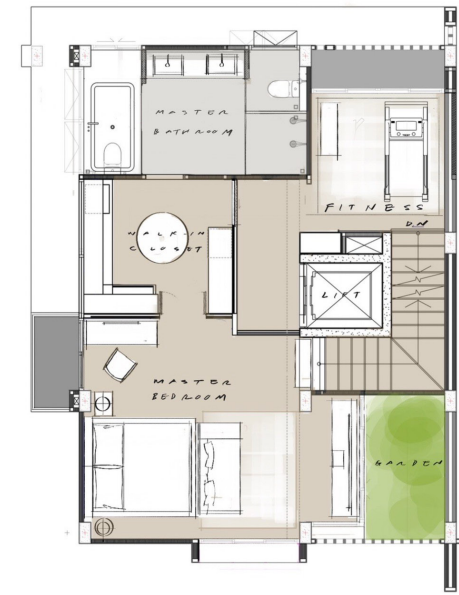

3rd FLOOR PLAN



3 Bedrooms



4 Bathrooms



1 Multi-purpose
Room



3 Parking
Space



1 Maid's Rooms



Lift

EXTERIOR



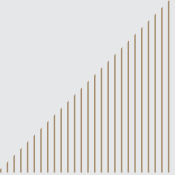



INTERIOR

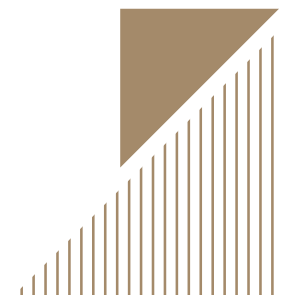

Founders

of Rising Plus Development Co.,Ltd.



**Neramit
Srangiam (Tui)**

Having gained extensive experience from numerous successful vertical living projects, Tui recognizes that his expertise can be seamlessly applied to horizontal housing as well, adhering to his guiding principle of meticulous consideration to ensure every investment is truly worthwhile.



NEO SPACE PLUS
Sukhonhasawat 3 Intersection 3



NEO HAUS PLUS
Nak Niwat 32



SENSE BY NEO GROUP
Nak Niwat 48



NEO SPACE @ WORK
Ladphrao 41



NEO HAUS
Ladphrao 71



NEO SPACE
Sukhonhasawat 3



BRITLOFT
Ladphrao 71



BRITLOFT PRIME
KASET-NAWAMIN



BRITTON
Ladphrao 41



Developer

Chonlachat Boonyiabyian (Tar)

Developer of Neo Group Projects
and Baan Sang Mitr Co., Ltd

Driven by his conviction in housing development that optimally caters to urban lifestyles, Tar meticulously evaluates and analyses every usable inch of design, to ensure utmost consideration for the well-being and comfort of the residents.



Architect

Kannika Rattanapreedakul (Lek)

Architect who supervises
Baan Baan Project, Vibhavadi 20

Lek from Spacetime Architects assumes the role of an architect entrusted with designing houses for ‘*Baan Baan Project*’, Her design philosophy unequivocally revolves around the harmonious integration of the environment and a healthy lifestyle, firmly believing that such an approach fosters an intimate connection between the residents and her architectural creations.

Prior to her involvement in ‘*Baan Baan Project*’, Lek’s professional experience had been predominantly focused on detached house projects. She had not previously undertaken any development projects for sale.



Homeipital

Physically ill but not mentally ill
Ratchaphruek Hospital
Khon Kaen Province



Baan Khao Loi

Little houses in a big forest that
use shutters around the houses



Baan Phu Patra

Houses on the hill with
a basement floor



Baan Thai E-san

Cosy houses in the countryside

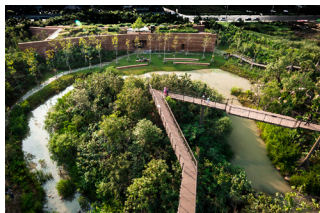

Metro Forest Project

A forest in the city



Baan Rayong

Well, mountain, bamboo lines,
durian and mangosteen
plantations and bare cement



Interior Designer

Rangsan Narathasajan (Noom)

Interior Designer and Design Director
at Niiq, a prestigious furniture brand

In addition to our distinctive architectural design, the interior design and landscape architecture for our ‘*Baan Baan Project*’ are expertly curated by Noom, a skilled professional who adeptly bridges the connection between the exterior and interior elements.

‘*Baan Baan Project*’ represents a new chapter, embarking on a noble mission to transform mere houses into warm and welcoming homes that embrace all inhabitants, fostering a sense of belonging and alleviating any feelings of solitude among the residents.

niiq

Scan QR Code
Website niiq

รับชมผลงานเพิ่มเติมได้ที่



AWARD

The Association of Siamese Architects
under Royal Patronage

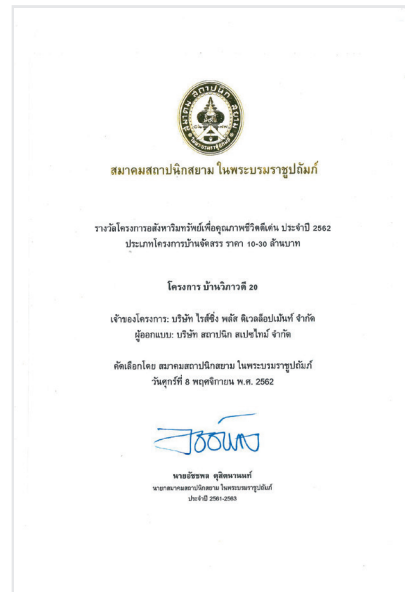

Honouring the Best in Real Estate
for a Better Quality of Life 2019

ASA REAL ESTATE AWARDS 2019



สมาคม
สถาปนิกสยาม
ในพระบรมราชูปถัมภ์



RESIDENTIAL LOW RISE

FIABCI-THAI PRIX D'EXCELLENCE
AWARDS 2019



LOCATION

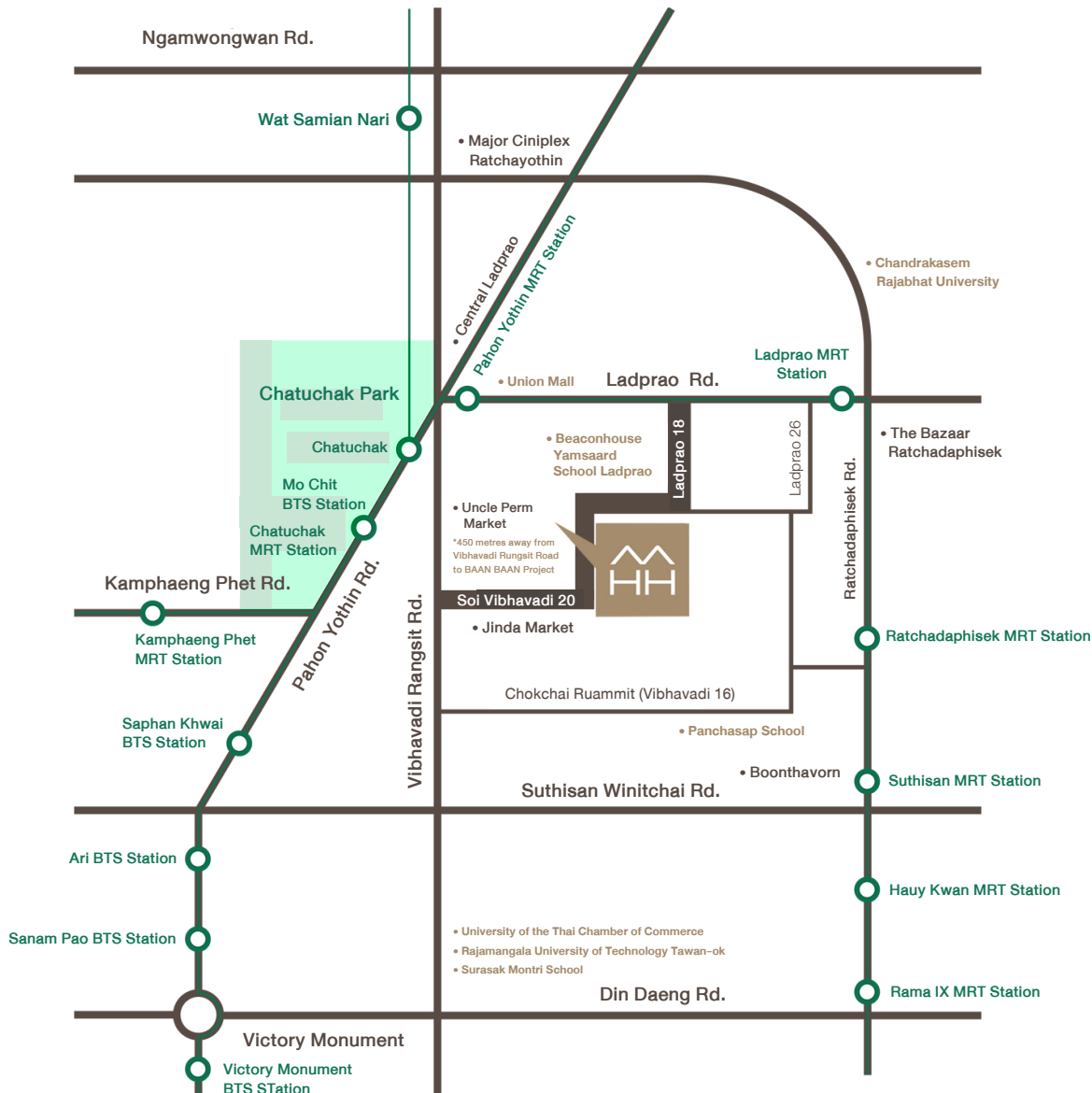

(We are near) Head Offices of

Thai Airways/ Bangkok Airways/ Energy Complex/
Chevron/ Sun Tower/ PPTV Station/ Channel 7HD
Station/Siam Commercial Bank/ Government
Savings Bank

Schools – Universities

Beaconhouse Yamsaard School Ladprao/ Surasak Montri
School/ Kasetsart University/ Chandrakasem Rajabhat
University/ University of the Thai Chamber of Commerce/
Panchasap School/ Rajamangala University of Technology
Tawan-ok

Markets – Malls

Major Ciniplex Ratchayothin/ Central Ladprao/Union Mall/
The Bazaar Ratchadaphisek/ Jinda Market/ Uncle Perm
Market/ Boonthavorn

Green Line BTS Stations

- Mo Chit BTS Station/ Lad Prao Intersection

Blue Line MRT Stations

- Ladprao MRT Station/ Pahon Yothin MRT Station



099-393-7272



BaanBaan@tnp.co.th



BaanBaanvibhavade20



www.BaanBaan.inith



Scan QR Code
Location Map

SCAN QR CODE

To follow us and for more information



Facebook Page



Youtube





BAAN BAAN

Vibhavadi 20





BAAN BAAN

Vibhavadi 20